

# K12 Level Switch with main power supply (115/230VAC)



## MAIN FEATURES

- lubricating oil reservoir level monitoring
- immediate sight glasses replacement
- critical fluid level detection on machine tools, chillers and any industrial OEM equipment
- monitoring refrigerant liquid level in both horizontal and vertical liquid receivers
- monitoring oil level in oil reservoirs
- P.O.E. Oil and Refrigerant Fluids compatibility

## Application Description

The optical level switch has been designed for use in level monitoring applications for the control of oil for screw compressors and can be fitted directly to crankcase or to the separator (internal or external) of the compressor. The switch has no moving parts, thus it is particularly suited for monitoring critical media where high reliability is needed.

The switch gives an alarm when low (or high) liquid level is detected.

It combines the 90-230VAC Power Supply with the high temperature resistance (up to 125°C) and a variety of possible threads.

## Operating Principle

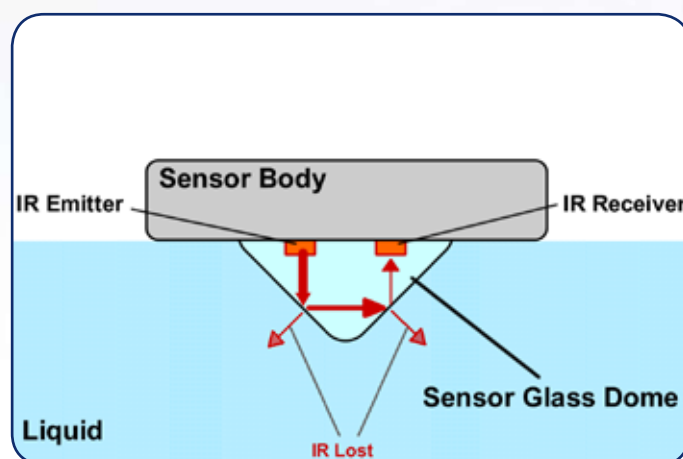
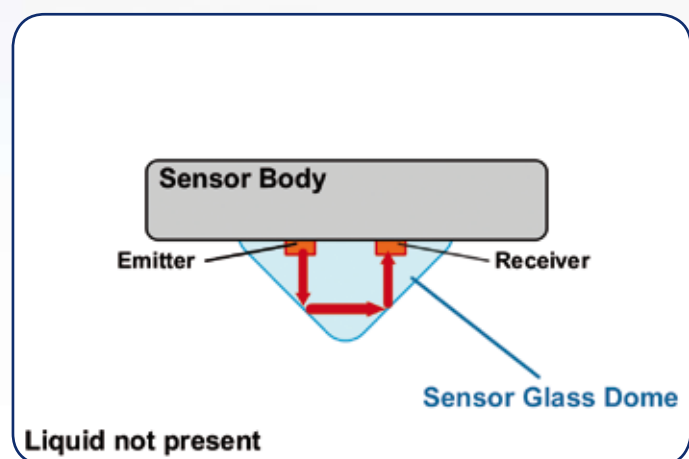

The sensors contains an infrared-ray emitter and an optical receiver. In air (liquid not present), all the light emitted is reflected - internally - by the dome and then redirected to the receiver. When the liquid reaches the sensor dome, a big amount of the light emitted is lost in the liquid and the sensor senses its presence.

# K12 Level Switch

## with main power supply (115/230VAC)

### Technical Data

<b>OPERATION MODE</b>	Detect liquid presence with contact
<b>REPEATABILITY</b>	± 2 mm.
<b>BODY MATERIALS</b>	Stainless Steel
<b>SENSIBLE DOME</b>	Glass
<b>ELECTRONIC PROTECTIONS</b>	Transient over voltage
<b>MAX. TEMPERATURE RANGE</b>	From -40°C up to +125°C
<b>STORAGE TEMPERATURE</b>	From -40°C up to +125°C
<b>SUPPLY VOLTAGE</b>	90 – 230VAC @ 50 /60Hz
<b>SUPPLY CURRENT</b>	20mA max. during normal operation
<b>OUTPUT TYPE</b>	AC solid state output
<b>AC/DC OUTPUT CURRENT</b>	up to 200 mA Max (depending on temperature range)
<b>OUTPUT MODE</b>	Output Normally Open or Closed in air
<b>DELAY TIMES</b>	Customizables depending on application needs
<b>MAX PRESSURE</b>	up to 45 bar
<b>TORQUE TIGHTEN</b>	40 Ntm

### Mechanical Dimensions

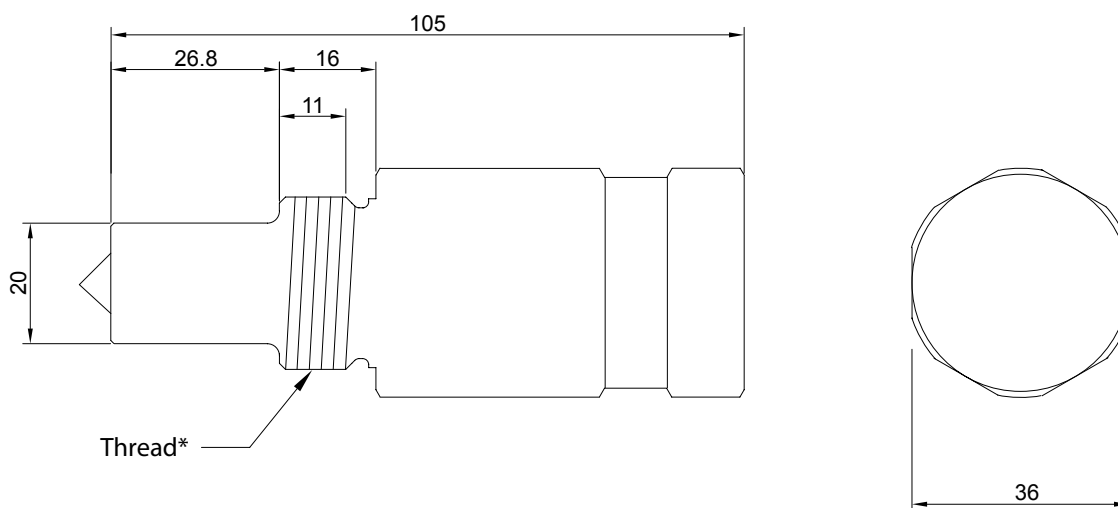

Quotes in mm

\*Available threads: 3/4" NPT, 1"1/8 18 UNEF.



Via Emilia Ovest, 1179 - 41123 Modena - Italy  
Tel. +39 059 375498 - Fax +39 059 376294  
info@teklab.biz - www.teklab.biz